

2026CPT.12.10.20182, ETC.

DL00368

**This electronic collection of documents is provided  
for the convenience of the user  
and is Not a Certified Document –**

**The documents contained herein were originally issued  
and sealed by the individuals whose names and license  
numbers appear on each page, on the dates appearing  
with their signature on that page.**

**This file or an individual page  
shall not be considered a certified document.**

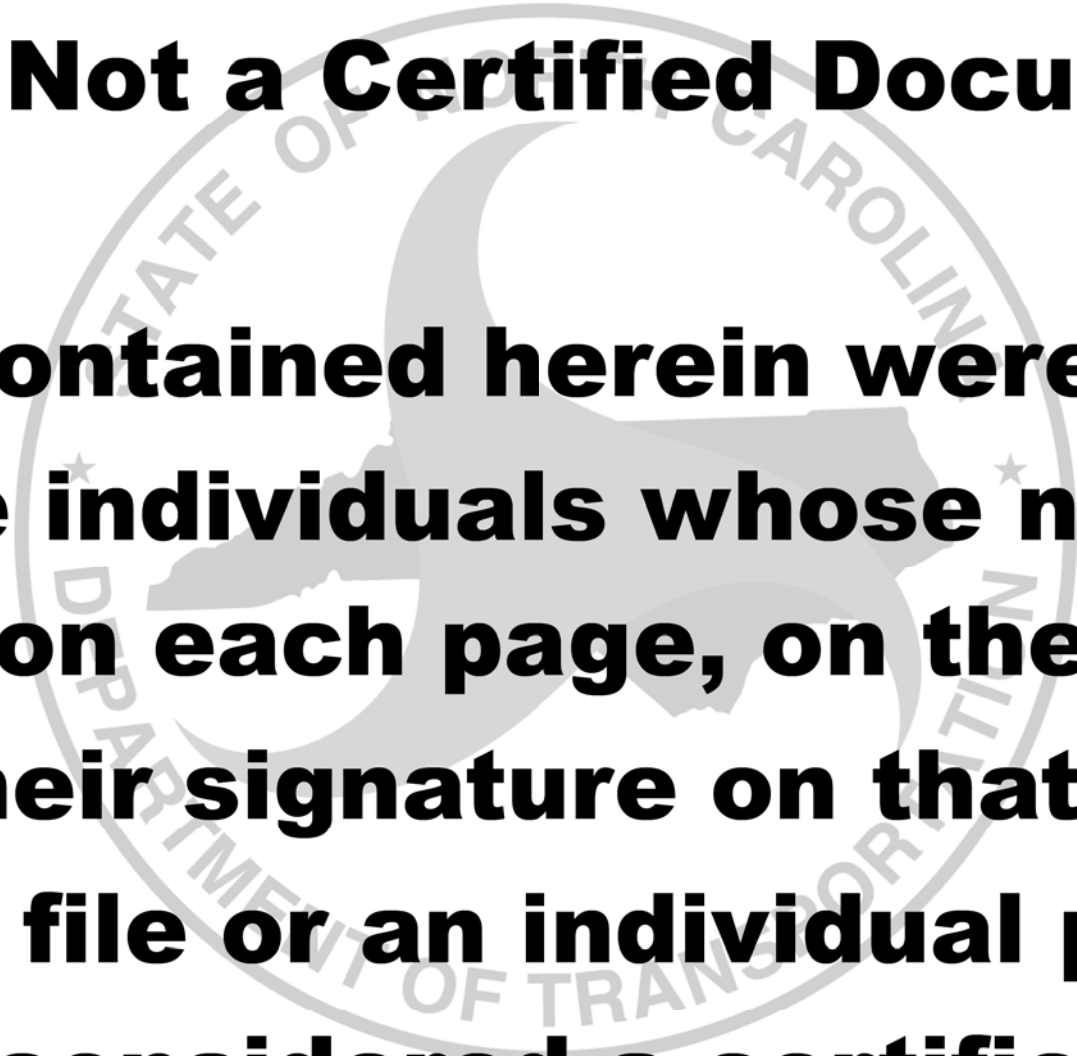

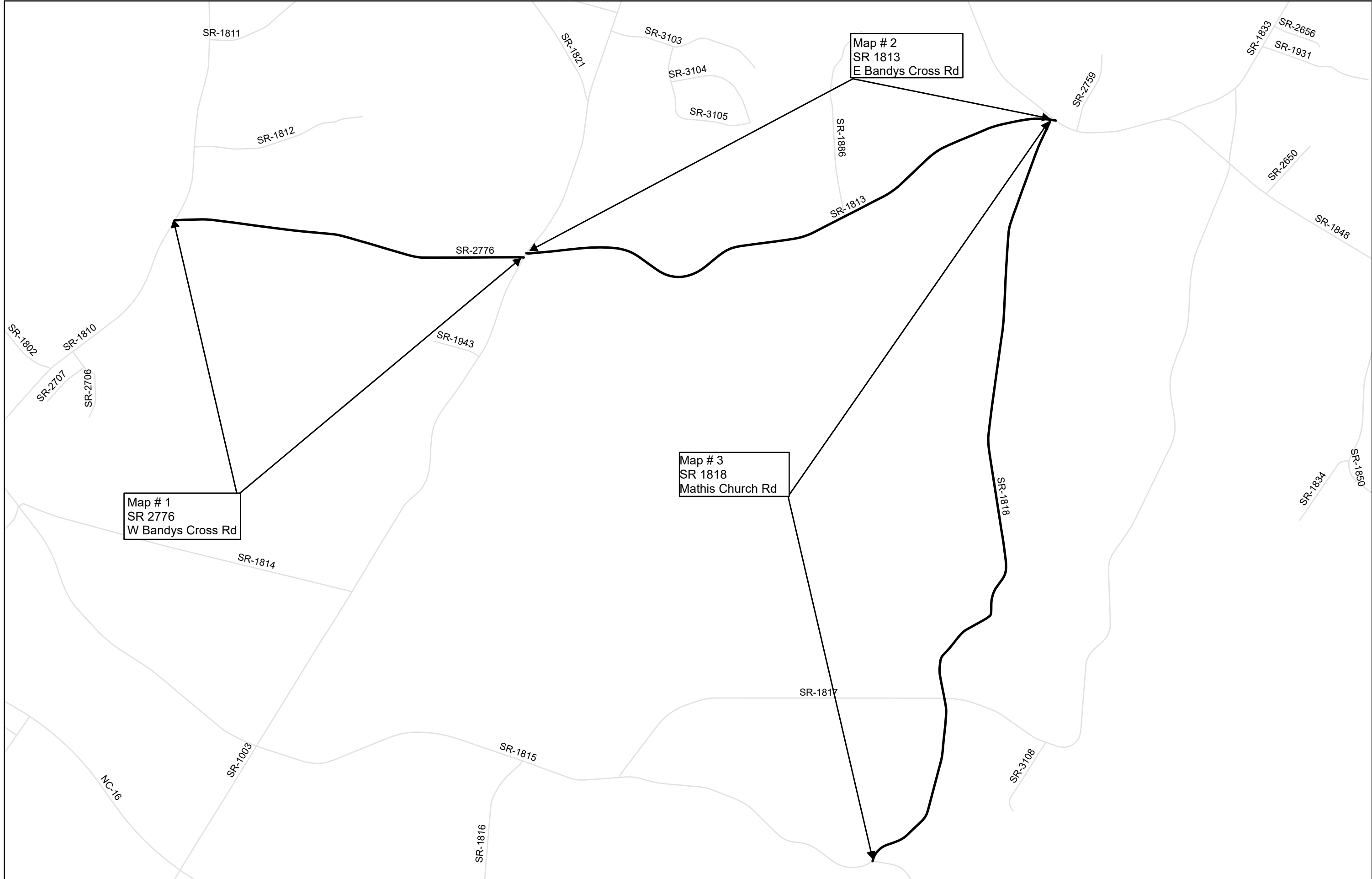

Map # 1  
SR 2776  
W Bandys Cross Rd

Map # 2  
SR 1813  
E Bandys Cross Rd

Map # 3  
SR 1818  
Mathis Church Rd



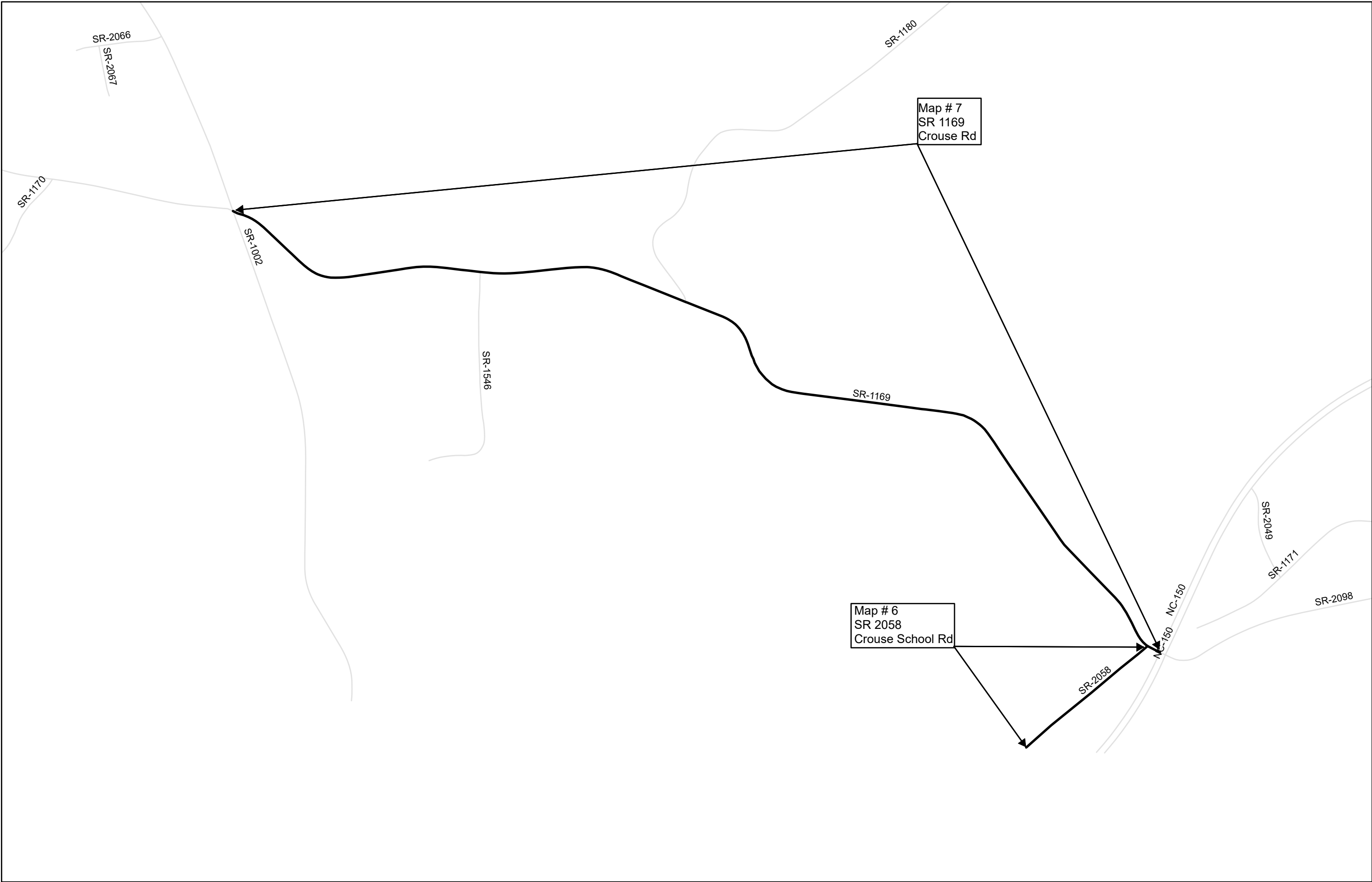





STATE	PROJECT WBS	SHEET NUMBER
NC	2026CPT.12.10.20102	7
	2026CPT.12.10.20552	

Checked by:

Drawn by: G. Brittain

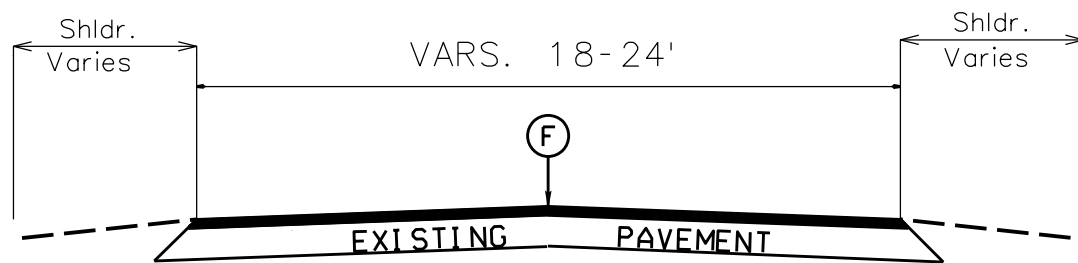

TYPICAL SECTION NO. 1

Al I Maps

PAVEMENT SCHEDULE	
F	Latex Modified Microsurfacing Type III at an Application Rate of 22 to 26 Pounds per Square Yard

2025-2026  
PAVEMENT PRESERVATION  
CATAWBA AND LINCOLN  
COUNTIES



PROJECT NO.	SHEET NO.	TOTAL NO.
2026CPT.12.10.20182		
2026CPT.12.10.20552		

## SUMMARY OF QUANTITIES

PROJECT NO	COUNTY	MAP NO	ROUTE	DESCRIPTION	TYP NO	LANES	LANE TYPE	LENGTH	WIDTH	BEGIN MP	END MP	1891000000-E	2413000000-E
								MI	FT			LATEX MOD MICROSURFACE, TYPE III	BLOTTING SAND
												SY	TON
2026CPT.12.10.20182	Catawba	1	SR-2776 / W BANDYS CROSS RD	FROM SR 1003 (BUFFALO SHOALS RD) TO SR 1810 (BALLS CREEK RD)	1	2	2WU	1.4	20	0	1.4	17,741	
2026CPT.12.10.20182	Catawba	2	SR-1813 / E BANDYS CROSS RD	FROM SR 1003 (BUFFALO SHOALS RD) TO SR 1848 (SHERRILLS FORD RD)	1	2	2WU	2.31	20	0	2.31	28,459	2
2026CPT.12.10.20182	Catawba	3	SR-1818 / MATHIS CHURCH RD	FROM SR 1813 (E BANDYS CROSS RD) TO SR 1815 (LITTLE MOUNTAIN RD)	1	2	2WU	3.2	20	0	3.2	39,424	3
<b>TOTAL FOR PROJ NO. 2026CPT.12.10.20182</b>								<b>6.91</b>				<b>85,624</b>	<b>5</b>
2026CPT.12.10.20552	Lincoln	4	SR-1136 / LARRY DAVIS RD	FROM SR 1139 (DAVIDS CHAPEL CH RD) TO DEAD END	1	2	2WU	0.52	20	0	0.52	6,406	
2026CPT.12.10.20552	Lincoln	5	SR-1159 / LEONHART RD	FROM SR 1140 (FLAY RD) TO NC 182	1	2	2WU	1.68	18	0	1.68	18,628	
2026CPT.12.10.20552	Lincoln	6	SR-2058 / CROUSE SCHOOL RD	FROM SR 1169 (CROUSE RD) TO GASTON CO	1	2	2WU	0.22	18	0	0.22	2,439	
2026CPT.12.10.20552	Lincoln	7	SR-1169 / CROUSE RD	FROM NC 150 TO SR 1002 (SHOAL RD)	1	2	2WU	2.14	24	0	2.14	31,638	2
2026CPT.12.10.20552	Lincoln	8	SR-1322 / FREEMAN RD	FROM SR 1001 (SALEM CH RD) TO DEAD END	1	2	2WU	0.71	18	0	0.71	7,872	
2026CPT.12.10.20552	Lincoln	9	SR-1309 / MAGNOLIA GROVE RD	FROM SR 1001 (PROVIDENCE CH RD) TO RR TRAX	1	2	2WU	2.83	20	0	2.83	34,866	3
2026CPT.12.10.20552	Lincoln	10	SR-1314 / WILL SCHRONCE RD	FROM SR 1001 (PHILADELPHIA CH RD) TO SR 1316 (DEPOT ST)	1	2	2WU	2.98	20	0	2.98	36,714	3
2026CPT.12.10.20552	Lincoln	11	SR-1314 / LOW BRIDGE RD	FROM SR 1357 (RANDLEMAN RD) TO NC 73	1	2	2WU	1.4	20	0	1.4	17,248	
2026CPT.12.10.20552	Lincoln	12	SR-1279 / SUMMEROW RD	FROM US 321 BUS TO CATAWBA CO	1	2	2WU	2.53	20	0	2.53	31,170	2
2026CPT.12.10.20552	Lincoln	13	SR-1273 / BIGGERSTAFF RD	FROM SR 1274 (MAIDEN SALEM RD) TO CATAWBA CO	1	2	2WU	0.47	20	0	0.47	5,790	
<b>TOTAL FOR PROJ NO. 2026CPT.12.10.20552</b>								<b>15.48</b>				<b>192,771</b>	<b>10</b>
<b>GRAND TOTAL</b>								<b>22.39</b>				<b>278,395</b>	<b>15</b>

PROJECT NO.	SHEET NO.	TOTAL NO.
2026CPT.12.10.20182		
2026CPT.12.10.20552		

### THERMOPLASTIC AND PAINT QUANTITIES

PROJECT NO	COUNTY	MAP NO	ROUTE	DESCRIPTION	TYP NO	LANES	LANE TYPE	LENGTH	WIDTH	BEGIN MP	END MP	4413000000-E	4457000000-N	4704000000-E	4709000000-E	4720000000-E		4810000000-E		4850000000-E	4870000000-E	4875000000-N
								MI	FT			WORK ZONE	TEMP	THERMOPLASTIC	24" X 90 MILS	THERMO MSG	THERMO RXR	4" WHITE	4" YELLOW	4" LINE	24" LINE	REMOVAL OF
												SF	LS	LF	LF	EA	EA	LF	LF	LF	LF	EA
2026CPT.12.10.20182	Catawba	1	SR-2776 / W BANDYS CROSS RD	FROM SR 1003 (BUFFALO SHOALS RD) TO SR 1810 (BALLS CREEK RD)	1	2	2WU	1.4	20	0	1.4	120			34			29,600	29,600	29,575	34	
2026CPT.12.10.20182	Catawba	2	SR-1813 / E BANDYS CROSS RD	FROM SR 1003 (BUFFALO SHOALS RD) TO SR 1848 (SHERRILLS FORD RD)	1	2	2WU	2.31	20	0	2.31	150			114	12		48,800	48,800	48,800	114	12
2026CPT.12.10.20182	Catawba	3	SR-1818 / MATHIS CHURCH RD	FROM SR 1813 (E BANDYS CROSS RD) TO SR 1815 (LITTLE MOUNTAIN RD)	1	2	2WU	3.2	20	0	3.2	200						67,600	67,600	67,600		
<b>TOTAL FOR PROJ NO. 2026CPT.12.10.20182</b>								<b>6.91</b>				<b>470</b>			<b>148</b>	<b>12</b>		<b>146,000</b>	<b>146,000</b>	<b>145,975</b>	<b>148</b>	<b>12</b>
																<b>12</b>		<b>292,000</b>				
2026CPT.12.10.20552	Lincoln	4	SR-1136 / LARRY DAVIS RD	FROM SR 1139 (DAVIDS CHAPEL CH RD) TO DEAD END	1	2	2WU	0.52	20	0	0.52	48										
2026CPT.12.10.20552	Lincoln	5	SR-1159 / LEONHART RD	FROM SR 1140 (FLAY RD) TO NC 182	1	2	2WU	1.68	18	0	1.68	150						35,500	35,500			
2026CPT.12.10.20552	Lincoln	6	SR-2058 / CROUSE SCHOOL RD	FROM SR 1169 (CROUSE RD) TO GASTON CO	1	2	2WU	0.22	18	0	0.22	48						4,650	4,650			
2026CPT.12.10.20552	Lincoln	7	SR-1169 / CROUSE RD	FROM NC 150 TO SR 1002 (SHOAL RD)	1	2	2WU	2.14	24	0	2.14	190						45,200	45,200			
2026CPT.12.10.20552	Lincoln	8	SR-1322 / FREEMAN RD	FROM SR 1001 (SALEM CH RD) TO DEAD END	1	2	2WU	0.71	18	0	0.71	48						15,000	15,000			
2026CPT.12.10.20552	Lincoln	9	SR-1309 / MAGNOLIA GROVE RD	FROM SR 1001 (PROVIDENCE CH RD) TO RR TRAX	1	2	2WU	2.83	20	0	2.83	235			40	30	2	59,775	59,775		70	2
2026CPT.12.10.20552	Lincoln	10	SR-1314 / WILL SCHRONCE RD	FROM SR 1001 (PHILADELPHIA CH RD) TO SR 1316 (DEPOT ST)	1	2	2WU	2.98	20	0	2.98	245			80	60	4	62,940	62,940		140	4
2026CPT.12.10.20552	Lincoln	11	SR-1314 / LOW BRIDGE RD	FROM SR 1357 (RANDLEMAN RD) TO NC 73	1	2	2WU	1.4	20	0	1.4	140						29,575	29,575			
2026CPT.12.10.20552	Lincoln	12	SR-1279 / SUMMEROW RD	FROM US 321 BUS TO CATAWBA CO	1	2	2WU	2.53	20	0	2.53	180						53,440	53,440			
2026CPT.12.10.20552	Lincoln	13	SR-1273 / BIGGERSTAFF RD	FROM SR 1274 (MAIDEN SALEM RD) TO CATAWBA CO	1	2	2WU	0.47	20	0	0.47	48						9,930	9,930			
<b>TOTAL FOR PROJ NO. 2026CPT.12.10.20552</b>								<b>15.48</b>				<b>1,332</b>			<b>120</b>	<b>90</b>	<b>6</b>	<b>316,010</b>	<b>316,010</b>		<b>210</b>	<b>6</b>
																<b>6</b>		<b>632,020</b>				
<b>GRAND TOTAL</b>								<b>22.39</b>				<b>1,802</b>	<b>1</b>	<b>120</b>	<b>238</b>	<b>12</b>	<b>6</b>	<b>462,010</b>	<b>462,010</b>	<b>145,975</b>	<b>358</b>	<b>18</b>
																<b>18</b>		<b>924,020</b>				

# SIGNING FOR ASPHALT SURFACE TREATMENT

**LEGEND**

- ▷ PORTABLE SIGN
- └ STATIONARY SIGN
- ← DIRECTION OF TRAFFIC FLOW

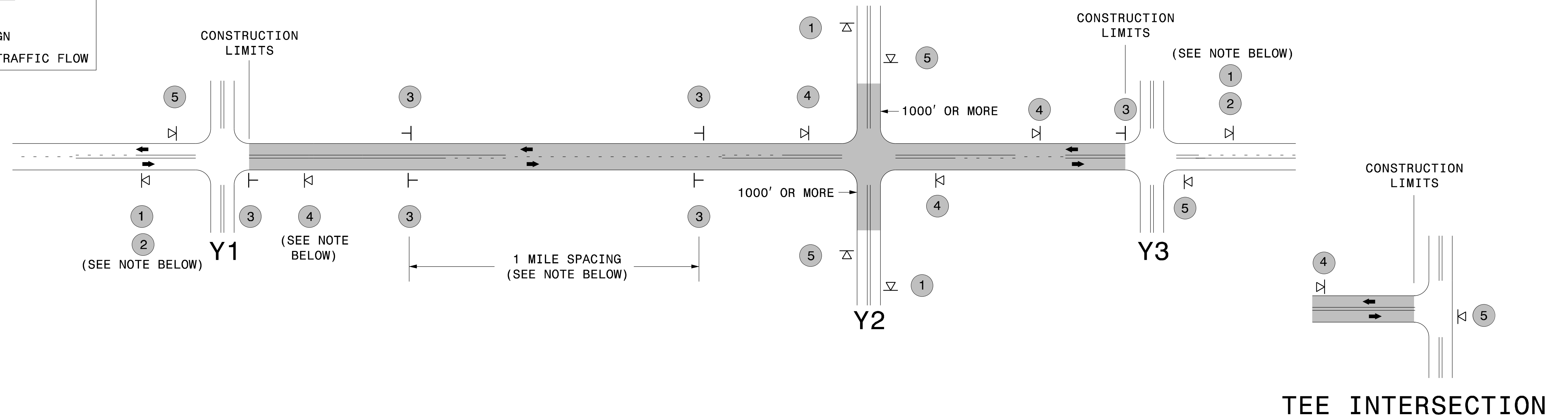

## MAINLINE (-L-) SIGNING

## -Y- LINE SIGNING

SIGNING NOTES AND PLACEMENT PER DIRECTION	1		- PLACE 1000' PRIOR TO BEGINNING OF CONSTRUCTION LIMITS. ONLY USED ON -Y- LINES IF RESURFACING LIMITS EXTEND 1000' ALONG -Y- LINE.	<p>STATIONARY SIGNING NOT REQUIRED FOR THE FOLLOWING -Y- LINE CONDITIONS:</p> <ol style="list-style-type: none"> <li>1) LESS THAN 1000' OF RESURFACING ALONG -Y- LINE</li> <li>2) SUBDIVISION ROADS</li> <li>3) DEAD END ROADS</li> </ol> <p>WHEN PAVING/CONSTRUCTION ACTIVITIES PROCEED ACROSS AN UNSIGNED -Y- LINE, PORTABLE ADVANCE WARNING SIGNS SHALL BE USED ALONG THE -Y- LINE AS SHOWN BELOW. REMOVE UPON COMPLETION OF WORK.</p> <div style="display: flex; justify-content: space-around;"> <div style="text-align: center;">               W20-1 48" X 48" PLACED 500' IN ADVANCE OF FLAGGER.         </div> <div style="text-align: center;">               W20-7 A 48" X 48" PLACED 250' IN ADVANCE OF FLAGGER.         </div> </div>
	2		- SIGN #2 ONLY USED WHEN RESURFACING LIMITS ARE 2 OR MORE MILES IN LENGTH. ROUND UP TO THE NEAREST WHOLE NUMBER. DO NOT USE FRACTIONAL OR DECIMAL NUMBERS.	
	3	 	- ALTERNATE THE FOLLOWING TWO SIGNS: - STARTING WITH "LOOSE GRAVEL" (W8-7) FOLLOWED BY "UNMARKED PAVEMENT". - PLACE INITIALLY AT THE CONSTRUCTION LIMITS AND SPACED 1 MILE APART THEREAFTER. - AT TEE INTERSECTIONS INSTALL INITIALLY 0.5 MILE FROM INTERSECTION AND SPACE 1 MILE APART THEREAFTER.	
	4		- THESE ARE FOR -Y- LINES THAT ARE "THROUGH" ROADWAYS. DEAD END AND SUBDIVISION ROADS ARE NOT "THROUGH" ROADWAYS. - INSTALL 500' +/- FROM EACH -Y- LINE APPROACH AS SHOWN ABOVE. - FOR MULTIPLE -Y- LINES THAT ARE SEPARATED BY 0.25 MILES OR LESS, TREAT AS A SINGLE UNIT AND INSTALL WITHIN 500' OF EACH APPROACH. - A MAXIMUM OF 2 SIGN SETS PER MILE. DO NOT INSTALL WHEN -Y- LINES ARE WITHIN 0.5 MILES FROM "END ROAD WORK" SIGN.	
	5		PLACE 500' FOLLOWING THE END OF CONSTRUCTION LIMITS OR AS SHOWN WHEN WORK ENDS AT A 3-WAY TEE INTERSECTION.	

THE ABOVE SIGNS ARE ALL THAT ARE REQUIRED FOR A CONTRACTOR TO BEGIN A RESURFACING CONTRACT. ANY ADDITIONAL SIGNS REQUESTED BY NCDOT DIVISIONS SHALL BE INSTALLED WITHIN 7 BUSINESS DAYS OF THE START OF CONTRACT WORK.

### MAPS LESS THAN 2 MILES

FOR AST RESURFACING MAPS WITH CONSTRUCTION LIMITS LESS THAN 2 MILES IN LENGTH, USE A STATIONARY "LOOSE GRAVEL" SIGN AT THE BEGINNING CONSTRUCTION LIMIT FOLLOWED BY AN "UNMARKED PAVEMENT" SIGN MIDWAY THROUGH AND AN "END ROAD WORK" SIGN AT THE END CONSTRUCTION LIMIT.

**ADVANCE WARNING SIGNS FOR 2-LANE ROADWAY ASPHALT SURFACE TREATMENT**